

CAMDEN COUNCIL

CONTRIBUTIONS PLAN NO. 7

ROAD MAINTENANCE :
EXTRACTIVE INDUSTRY

ADOPTED : 25 / 10 / 93
FILE NO : TC / 3425 / 1

1. PURPOSE OF THE PLAN

The purpose of this Plan is to fund the cost of maintaining local roads used for the transport of extracted material to the nearest State or Regional Road or the Council boundary, by means of a road maintenance contribution imposed as a condition of development consent on all materials extracted within the Council area.

2. OBJECTIVES OF THE PLAN

The objectives of this Plan are to:

- (a) Provide a funding mechanism towards maintaining in good order those Council roads used by extractors to transport extractive materials;
- (b) Provide a means of apportioning the costs associated with maintaining these roads between Council and extractive industries;
- (c) Provide a Schedule of Works by which collected contributions are expended; and
- (e) Ensure effective and efficient achievement of Council's responsibilities pursuant to Section 94.

3. AREA TO WHICH THE PLAN APPLIES

This Plan applies to the areas shown on Map A in Appendix 1.

4. RELATIONSHIP BETWEEN THIS PLAN AND EXISTING PLANS AND POLICIES

This Plan relates to:

- Elderslie Sand and Soil deposits; Land Management Study, Volume VI - Summary Environmental Impact Statement ⁽¹⁾;
- Report on Road Maintenance Levy ⁽²⁾;
- Section 94 Contributions Plans Manual ⁽³⁾;
- Judgment - Colin C Donges & Associates v Baulkham Hills Shire Council ⁽⁴⁾;
- Judgement Capital Quarries V Gunning & Yass Shire Councils ⁽⁵⁾
- Local Environmental Plan No. 46 ⁽⁶⁾;
- Local Environmental Plan No. 48 ⁽⁷⁾;
- Regional Road Hierarchy Study ⁽⁸⁾;
- Sydney Regional Environmental Plan No. 9 ⁽⁹⁾.

5. ESTABLISHMENT OF NEXUS

5.1 Definitions

For the purpose of this Plan "Extractive Industry" shall mean

"an undertaking, not being a mine, which depends for its operations on the winning of extractive material from the land upon which it is carried on, and includes any washing, crushing, grinding, milling or separating into different sizes of that extractive material on that land."

and "Extractive Materials" shall have the following meanings:-

- (a) within the area covered by Sydney Regional Environmental Plan (REP) No. 9 (Extractive Industry) they shall be defined as:-

"sand, coarse aggregate, sandstone, clay/shale, loam and peat".

- (b) within all other areas they shall be as defined in the Environmental Planning and Assessment Model Provisions 1980 that is:-

"sand, gravel, clay, turf, soil, rock, stone and similar substance".

5.2 Importance of Deposits

Extractive materials are located primarily within the Elderslie sand and soil deposits and secondly, within various other sites in the Council area.

As the Sydney region has developed and more particularly since the Structure Plan for Campbelltown/Camden/Appin ⁽¹⁰⁾ has been implemented, extraction has changed from the occasional truck load to regular extraction. This situation is expected to continue as the older sources of these materials closer to Sydney become exhausted or sterilised.

The importance of extractive materials found within the Council area has been identified principally in the Elderslie Sand and Soil Deposits Land Management Study and in REP 9. The Elderslie study identified an estimated 14 million tonnes of sand and 2.9 million tonnes of soil as an important source of bricklayers sand, soil and washed river sands which are not found elsewhere.

The importance of these deposits at Elderslie was reinforced by REP 9 some years later. In addition to sand deposits the REP identified extensive resources of clay/shale within the Council area used in the manufacture of bricks and other structural clay products in the Sydney Region. It identified these as being of regional significance.

In addition to the deposits identified within REP 9, there are other sites within the Council area which contain significant quantities of material considered to be of similar importance.

The importance of all these deposits are summarised as follows:

- they can be extracted simply and economically;
- they are within economical transport distance of the Sydney Region;
- they are centrally located to the Campbelltown/Camden/Appin area; and
- they are serviced by major arterial road networks which link the sites to local and Sydney markets.

5.3 Power to Levy

Extractive industry, by the nature of its operation, requires heavy vehicles to transport the extracted material. It therefore follows that heavy vehicle movement within the vicinity of an extraction site will be greater than if no extraction site had been present and as a consequence of this increase, the degree of road pavement damage will also increase.

The power to levy contributions for road maintenance has been firmly established by the Land and Environment Court.

In *Collins C Donges Pty Ltd V Baulkham Hills Shire Council* (1989), Council may levy S.94 contributions for roads which it has a responsibility to maintain. Contributions for a road may be sought by Council even where the Roads & Traffic Authority (RTA) has taken over the maintenance from Council provided Council's responsibilities for that road remain and there is no agreement to the contrary under S.13(4) of the State Roads Act.

In *Capital Quarries Pty Ltd V Gunning & Yass Shire Councils* (1987), where, as a result of development, there is excessive wear and tear, contributions may be sought by Council for ongoing maintenance within its boundary.

In *Bridon V Kiama* (1990), the power to levy contributions does not extend to contributions being required for roads in an adjacent local government area. However, if a development straddles a local government area boundary, then each Council may levy contributions for the proportional part of the development within its boundary.

5.4 Report on Road Maintenance Levy

Following on from the judgement of the Land & Environment Court in the *Collins C Donges Pty Ltd V Baulkham Hills Shire Council* case mentioned above, it was determined that a contribution from extractors was required towards the repair and maintenance of Council's roads used to transport extractive materials.

In determining a contribution rate several unknown factors are encountered:

- location of potential extraction site;
- potential extraction quantities;
- the road network used to transport the extracted materials; and
- the design standards used when these roads were originally constructed.

In order to determine a contribution rate these unknown factors had to be minimised and to do this Council selected an existing extraction area, namely the Elderslie sand and soil deposits where, for a given time period, tonnages of extracted material, tonnages related to other usages, existing traffic data and catchment boundaries of the road network were all available.

The road network was limited to Springs, Richardson and part of Macarthur Roads.

In order to assess the existing road condition Council engaged Bankstown City Council to carry out testing of the existing road pavements with its road testing vehicle.

The object of the exercise was to calculate a road maintenance contribution (levy) that could be reasonably applied to new development consents for extractive industry throughout the Council area.

It was assumed that extraction sites outside the Elderslie sand and soil deposit would have similar tonnages and that the calculations applicable to the Elderslie area could also reasonably apply to other areas irrespective of the material to be extracted.

The Report on Road Maintenance Levy was presented to Council in February 1990.

The report outlined several options in applying the levy, noting also that Council would need to contribute to road maintenance to meet the proportionate costs incurred by extractive sites already approved and local traffic not associated with extractive industry.

Criteria used to calculate a road maintenance contribution (levy) based on the three test roads included:

- unapproved sand and soil extraction tonnages;
- total existing tonnages;
- future tonnages;
- road overlay costs;
- road reconstruction costs; and
- suitable road pavement design (using NAASRA guidelines⁽¹¹⁾).

6. CONTRIBUTION RATE

On February 26, 1990, Council adopted the recommendations of the Report on Road Maintenance Levy and in doing so, also adopted a contribution rate per tonne of extracted material applicable to new development consents for extractive industry throughout the Council area.

The rate was to be indexed to the RTA Road Cost Index.

The contribution rate for 1993 is shown in Table A1 in Appendix 2.

In addition, there are four extractive sites indicated as A,B,C & D on Map A in Appendix 2 for which contribution rates were already set prior to Council's adoption of the Report on Road Maintenance Levy.

The contribution rate for 1993 for these sites is indicated in Table A2 in Appendix 2.

7. INDEXATION

The road maintenance contribution rate will be adjusted annually from 1st January in accordance with the following formula:

$$AL = OL \times \frac{N_1}{B_1}$$

Where:

- AL is the adjusted contribution rate payable per tonne of material extracted and carried away from the land;
- OL is the contribution rate payable during the preceding year;
- N₁ is the index number applicable to the year ending 30th June immediately preceding the date of adjustment in accordance with the New South Wales Roads and Traffic Authority Road Cost Index for Urban Arterials - Road Enhancement.
- B₁ is the index number applicable to the year ending 30th June for the year previous to the year in which levy rates were last adjusted, in accordance with the New South Wales Roads and Traffic Authority Road Cost Index for Urban Arterials - Road Enhancement.

Should the Road Cost Index not be available or obsolete, the Consumer Price Index (all groups, Sydney) will be used in indexing the contribution rate.

8. GOODS AND SERVICES TAX

In circumstances where the cost of providing the public amenities and services identified in this Plan is increased as a result of Council becoming obliged to pay Goods and Services Tax (GST) for the supply of these public amenities and services, the contribution rate payable under this Plan will be increased by an equivalent amount.

9. APPORTIONMENT

Council's Report on Road Maintenance Levy contained data on tonnages related to Council's garbage trucks, feed trucks and local traffic, i.e. tonnages contributing to the need for road maintenance that could not be attributed to extractive industry. These tonnages represent the proportion of the contribution to be met by Council and is indicated in Table B in Appendix 2.

For the purposes of this Plan, Council's apportionment will apply to all sites within the Council area.

10. PAYMENT OF CONTRIBUTIONS

Contributions under this Plan will be levied via a condition of Development Consent on all developments for the purposes of extractive industry in accordance with the following formula:

$$C = AL \times T$$

where C is the contribution required under this Plan, rounded to the nearest dollar.

AL is the contribution rate as per Table A1 or A2 indexed in accordance with clause 7; and

T is the tonnage extracted per month.

Tables C1 and C2 in Appendix 2 indicate the anticipated contributions to be paid from the above formula together with the expected commencement and completion of operations at each extraction site.

The road maintenance contribution as indicated on the Development Consent will be paid monthly within ten (10) days of the last day of each calendar month during the life of the Consent.

With each monthly payment the extractor will provide Council with a certified statement indicating the quantity of material removed during the month.

The extractor will keep for at least two years after the end of each year during the life of the Consent, evidence of the quantities (e.g. delivery dockets, weighbridge slips) of extracted material moved in the previous year. Council will have the right to inspect and audit the books of account, statements, documents and files of the extractor relating to the removal of material. At the request of Council the extractor, will make that available for inspection or audit.

The extractor will pay to Council the cost of audit if the audited error exceeds 3%.

Should Council initiate a survey that identifies a variance of more than 8% between the certified statement and the material measured as extracted from the land, the extractor will pay the cost of survey.

Deferred payment of the contribution or a Bank Guarantee in lieu of monetary payment will not be accepted due to the need to meet expenditure commitments within the time frame set by the Schedule of Works.

11 SCHEDULE OF WORKS

The Schedule of Works is indicated in Table D in Appendix 2.

A time frame of twenty years from 1993 has been selected to allow for the ongoing nature of an extractive program. The selected time frame is subdivided into four year phases to provide some reasonable flexibility in the Schedule of Works.

Having regard to Council's historical record of road maintenance expenditure, the following categories and distribution of expenditure will apply to the Schedule.

(a) Minor Maintenance

Twelve and one half (12½) percent of contributions collected within a phase will be allocated to the minor maintenance of roads with the emphasis being on potholes, bitumen edge repair and maintenance of small pipe culverts.

(b) Heavy Patching and Resealing

Twenty five (25) percent of contributions collected within a phase will be allocated to heavy patching and resealing with the emphasis being on small road failures that have occurred usually on one travelling lane.

(c) Major Repair or Reconstruction

Sixty two and one half (62½) percent of contributions collected within a phase will be allocated to major repair or the reconstruction of failed lengths of road.

For the purpose of this Plan, anticipated contributions will be expended on Council roads as follows:

- In the case of the Elderslie sand and soil deposits – Springs Road, Richardson Road and Macarthur Road.
- In the case of areas outside of Elderslie - those roads as identified, from time to time, in any Environmental Impact Statement (EIS) relating to any extraction site for the period of operation of that extraction site. Such roads will be those that are used for the transport of extracted material to the nearest State or Regional Road as identified in Table E in Appendix 2.

With the exception of sites A, B, C and D identified on Map A, areas outside the Elderslie sand and soil deposits have no currently identified potential sites for extractive purposes. However, this does not mean that extractive materials are not present within these areas which may in the future, be the subject of a development application.

Due to the uncertainty of the location and extent of these sites it is not possible to incorporate them into this Plan or the Schedule of Works until such time as an EIS relating to a particular site is forthcoming. At that time, the Plan will be amended to incorporate the tonnages and contributions expected from that site.

As the Schedule of Works is based on an anticipated extraction program which is in turn dependant on market demand for the extracted material, any variation in the extraction program will have an influence on the amount of contribution available for expenditure. Variation in expenditure within a four year phase which results directly from a variation of the anticipated extraction program will not constitute grounds for the re-exhibition of re-approval of this Plan pursuant to Clause 41K(1) of the Regulation provided that the contributions collected within a four year phase are expended within that phase in the percentages as set out in the categories (a), (b) and (c) above.

12. REVIEW OF THE PLAN

This Plan will be reviewed by Council at the end of each 4 year phase of the Schedule of Works or such lesser time as Council deems necessary.

APPENDIX 1

MAPS

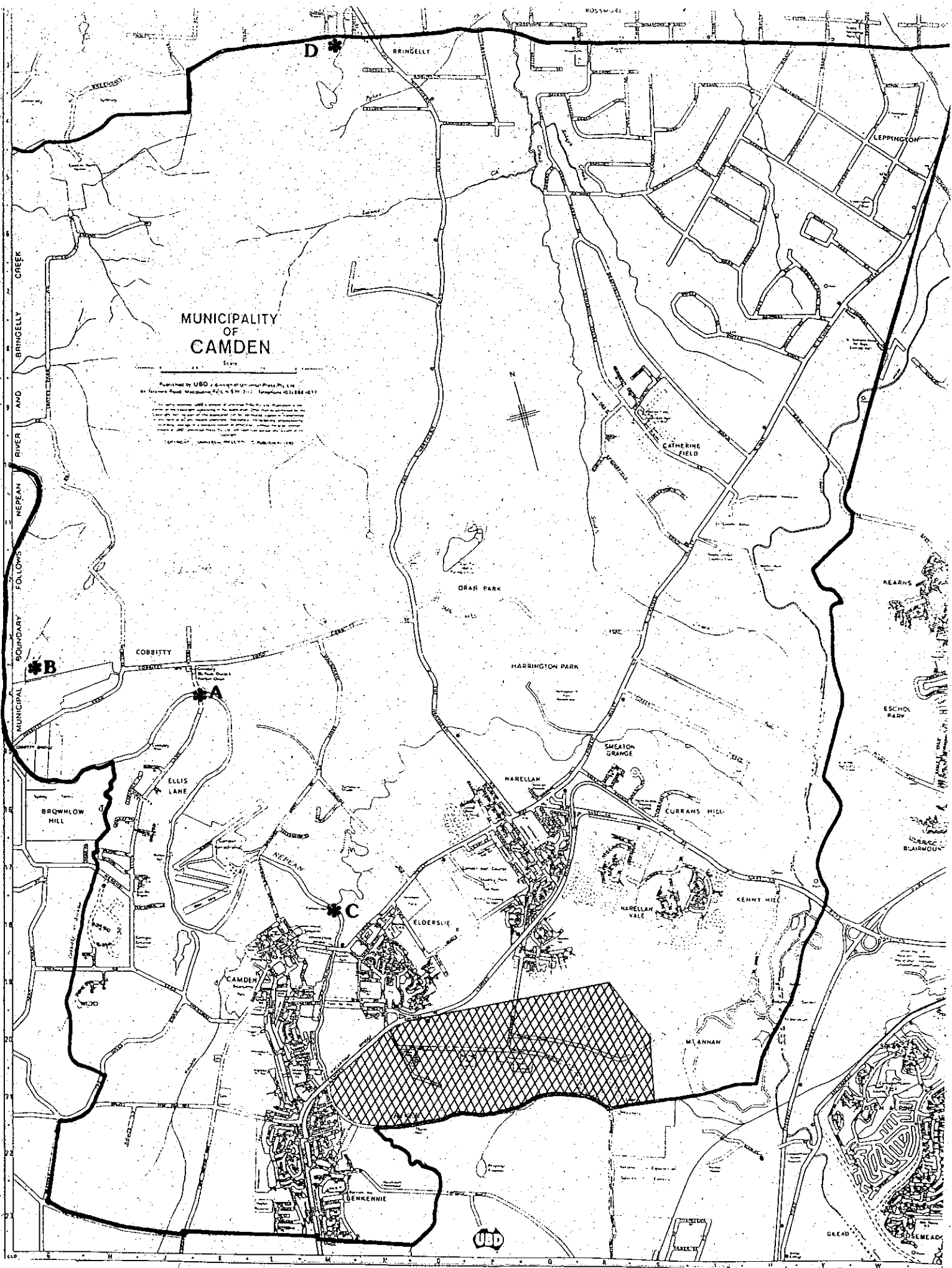

MAP A - AREAS TO WHICH THIS PLAN APPLIES



ELDERSLIE SAND AND SOIL DEPOSITS



A-D

OTHER EXTRACTION SITES WITH EXISTING DEVELOPMENT CONSENTS



COUNCIL BOUNDARY

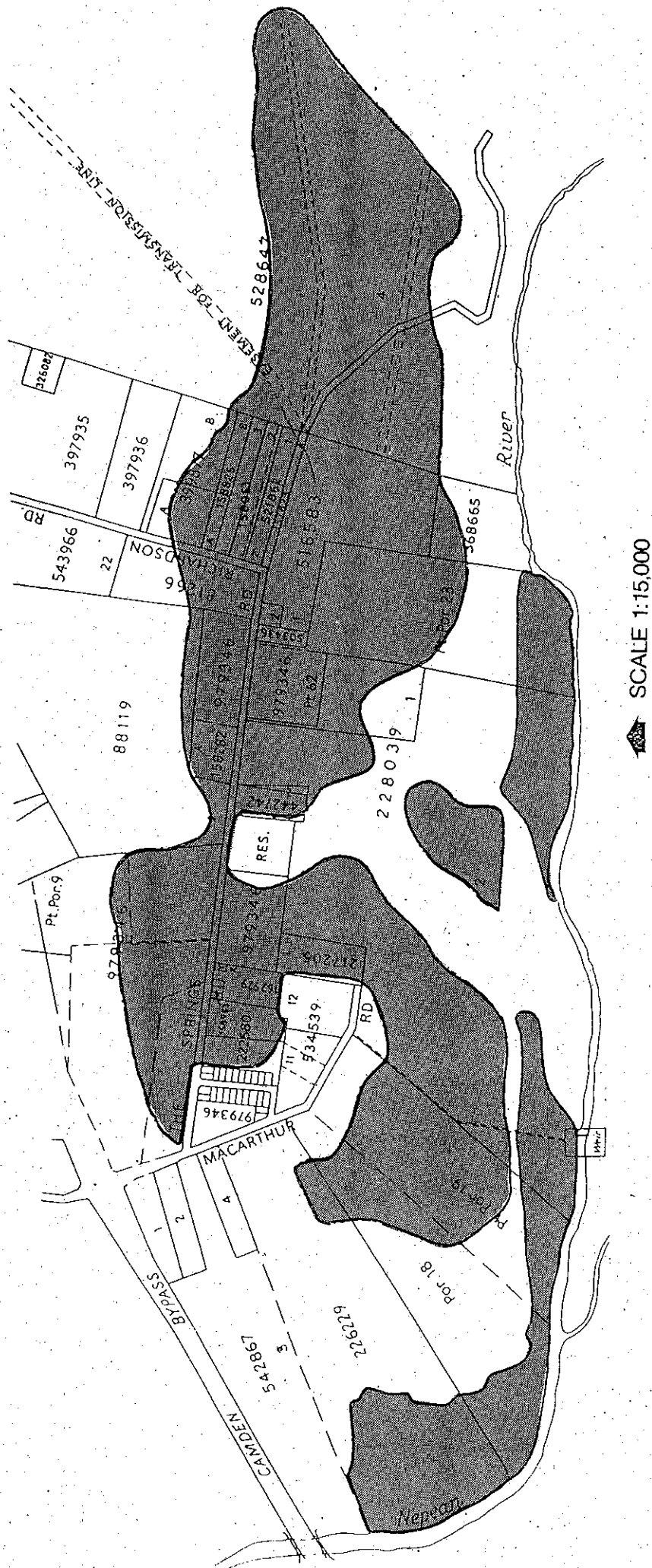

MAP B: EXTRACT FROM REGIONAL ENVIRONMENTAL PLAN NO.9 (EXTRACTIVE INDUSTRY)



SOURCE : DEPARTMENT OF PLANNING

**MAP C: EXTRACT FROM REGIONAL ENVIRONMENTAL PLAN NO.9
(EXTRACTIVE INDUSTRY)**

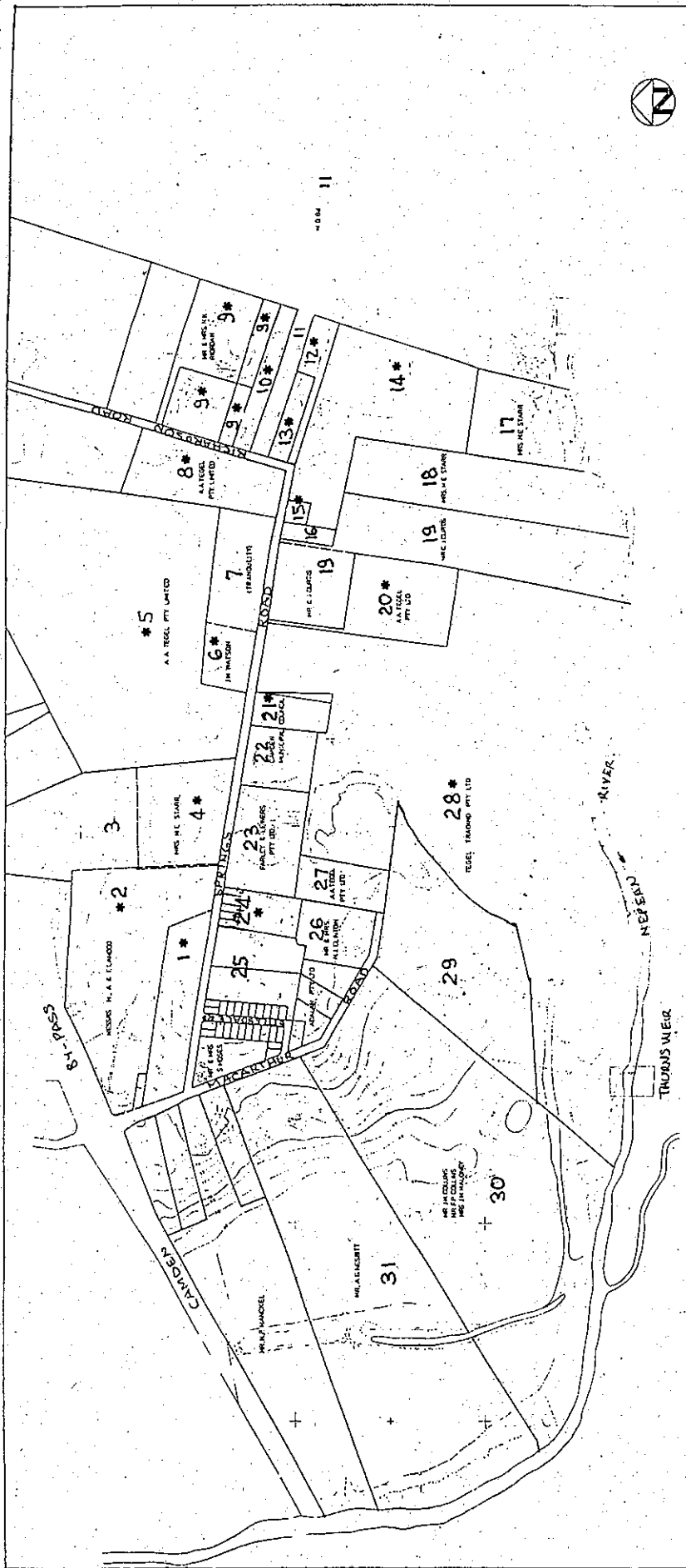

SITE	OWNER	SITES
1	Seovic Civil Engineering P/L	(1)
2	H.A.T. Lahood	(2)
3	JM & WC Tripodi	(3,7)
4	Mrs M.E. Starr - Hoxede P/L	(4,17,18)
5	A.A. Tegel P/L (Inghams)	(5,8,20,27)
6	Camelot Resources(Springs-Garmark)	(6,16,19)
7	NK & CF Riordan	(9)
8	Riordan Family Trust	(10)
9	Department of Housing	(11)
10	Clutha Services P/L	(12)
11	Springvale Sands P/L-Menangle S/S	(13,23,25)
12	Prospect County Council	(14,15)
13	Camden Municipal Council	(21,22,24)
14	N.J. Clinton	(26)
15	Indaal P/L - Cornish	(28)
16	Tegel Trading P/L	(29)
17	M. Collins & Sons	(30,31)

SITE	OWNER	SITE	OWNER
1	Seovic Civil Engineering P/L	17	Mrs M.E. Starr - Hoxede P/L
2	H.A.T. Lahood	18	Mrs M.E. Starr - Hoxede P/L
3	JM & WC Tripodi	19	Springs S/S-Camelot Resources
4	Mrs M.E. Starr	20	A.A. Tegel P/L (Inghams)
5	A.A. Tegel P/L (Inghams)	21	Camden Municipal Council
6	Camelot Resources(Springs-Garmark)	22	Camden Municipal Council
7	JM & WC Tripodi	23	Springvale Sands P/L-Menangle S/S
8	A.A. Tegel P/L (Inghams)	24	Camden Municipal Council
9	NK & CF Riordan	25	Springvale Sands P/L-Menangle S/S
10	Riordan Family Trust	26	N.J. Clinton
11	Department of Housing	27	A.A. Tegel P/L (Inghams)
12	Clutha Services P/L	28	Indaal P/L - Cornish
13	Springvale Sands P/L-Menangle S/S	29	Tegel Trading P/L
14	Prospect County Council	30	M. Collins & Sons
15	Prospect County Council	31	M. Collins & Sons
16	Springs S/S-Camelot Resources		

EXTRACTION SITES SUBJECT TO A ROAD MAINTENANCE CONTRIBUTION

MAP D - ELDERSLIE SAND AND SOIL DEPOSITS : EXTRACTION SITES

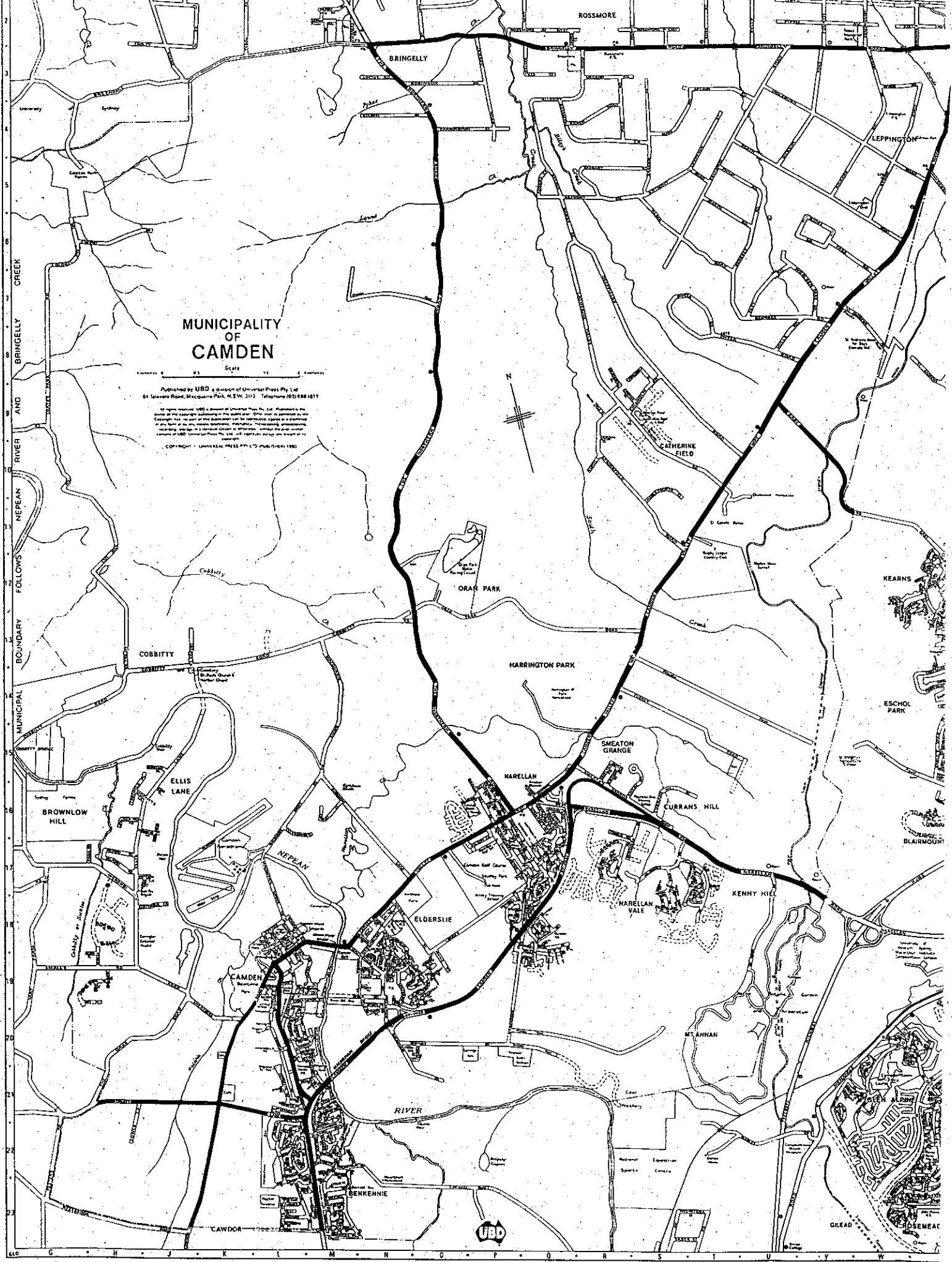

MAP E: STATE AND REGIONAL ROADS

APPENDIX 2

TABLES

TABLE A-1: CONTRIBUTION RATE FOR WHOLE COUNCIL AREA - NEW DEVELOPMENT CONSENTS AFTER 1/7/93 (in \$1993)

(DERIVED FROM COUNCILS REPORT ON ROAD MAINTENANCE LEVY)

TEST LOCATION	TOTAL TONNAGE	TOTAL COST	RATE \$/TONNE
RICHARDSON ROAD	6,604,400	\$2,606,800	0.3947
SPRINGS/MACARTHUR RDS	27,204,400	\$1,450,000	0.0533
TOTAL		\$4,056,800	0.4480

TABLE A-2: CONTRIBUTION RATE OUTSIDE ELDERSLIE - FOR EXISTING DEVELOPMENT CONSENTS (in \$1993)
(DERIVED FROM EXISTING DEVELOPMENT CONSENTS)

LOCATION	TOTAL TONNAGE	TOTAL COST	RATE \$/TONNE
SAND & SOIL AREAS	706,189	\$265,033	0.3753
BORAL BRICKS - GREENDALE ROAD	8,676,250	\$811,229	0.0935
TOTAL	9,382,439	\$1,076,262	-

TABLE B: APPORTIONMENT - WHOLE COUNCIL AREA (in \$1993)
(DERIVED FROM COUNCILS REPORT ON ROAD MAINTENANCE LEVY)

TEST LOCATION	TOTAL TONNAGE	TOTAL COST	RATE \$/TONNE	EXTRACTORS		OTHER (COUNCIL)	
				TONNAGE	CONTRIBUTION PROP'N %	TONNAGE	CONTRIBUTION PROP'N %
RICHARDSON ROAD	6,604,400	\$2,606,800	0.3947	2,712,700	41.07	3,891,700	58.93
SPRINGS/MACARTHUR RDS	27,204,400	\$1,450,000	0.0533	2,712,700	9.97	24,491,700	90.03
TOTAL	33,808,800	\$4,056,800	0.4480		29.96	\$2,841,462	70.04

TABLE C-1 ANTICIPATED CONTRIBUTIONS 1993 TO 2012 - ELDERSLIE SAND & SOIL DEPOSITS (in \$1993)
(CURRENTLY IDENTIFIED SITES WITH NO VALID DEVELOPMENT CONSENT AS AT 1/7/93)

LOCATION	SITE NO.	EXTRACTION TONNAGE	RATE \$/TONNE	PHASE 1 1993-1996	PHASE 2 1997-2000	PHASE 3 2001-2004	PHASE 4 2005-2008	PHASE 5 2009-2012	TOTAL
AA TEGEL SPRINGS RD (LOT1DP228039)	20	160,000	0.4480	\$23,893	\$47,786				\$71,679
CAMDEN COUNCIL NIGHT SOIL DEPOT	21	30,000	0.4480					\$13,440	\$13,440
H A & T LAHOOD	2	520,600	0.4480	\$29,154	\$116,616	\$87,462			\$233,232
MENANGLE(SPRINGVALE)S&S & CLUTHA	12,13	180,000	0.4480	\$26,880	\$53,760				\$80,640
MRS M E STARR(HOXEDE)	4	650,000	0.4480		\$58,240	\$116,480	\$116,480		\$291,200
CAMDEN COUNCIL ONEIL HOUSES	24	75,000	0.4480			\$16,800	\$16,800		\$33,600
RICHARDSON ROAD RESERVE		40,000	0.4480					\$17,920	\$17,920
IN K & C F RIORDAN	9,10	302,100	0.4480	\$54,136	\$81,204				\$135,340
SPRINGS ROAD RESERVE		455,000	0.4480			\$58,240	\$116,480	\$29,120	\$203,840
AA TEGEL CNR RICHARDSON ROAD	8	300,000	0.4480				\$107,520	\$26,880	\$134,400
TOTAL CONTRIBUTIONS				\$134,063	\$357,606	\$278,982	\$357,280	\$87,360	\$1,215,291

TABLE C-2: ANTICIPATED CONTRIBUTIONS 1993 TO 2012 (in \$1993)
(CURRENTLY IDENTIFIED SITES WITH CURRENT DEVELOPMENT CONSENTS AS AT 1/7/93)

LOCATION	SITE NO.	EXTRACTION TONNAGE	RATE \$/TONNE	PHASE 1 1993-1996	PHASE 2 1997-2000	PHASE 3 2001-2004	PHASE 4 2005-2008	PHASE 5 2009-2012	TOTAL
ELDERSLIE SAND & SOIL DEPOSITS									
AA TEGEL/WATSON BATTERS	5,6	15,000	0.4480	\$6,720					\$6,720
PROSPECT COUNTY COUNCIL	14,15	550,000	0.4480	\$109,511	\$109,511	\$27,378			\$246,400
SEOVIC CIVIL ENGINEERING	1	200,000	0.4480	\$89,600					\$89,600
WOODGRAND (INDAAL)- THURNS WEIR	28	190,000	0.4480	\$85,120					\$85,120
OUTSIDE ELDERSLIE									
NEPEAN DREDGING - ELLIS LANE	A	120,000	0.3753	\$30,024	\$15,012				\$45,036
COLLINS -KENMERE- COBBITTY RD	B	511,189	0.3753	\$47,962	\$47,962	\$47,962	\$47,962		\$191,849
FORDHAMS -ARGYLE ST(CAMDEN WEIR)	C	75,000	0.3753	\$28,148					\$28,148
BORAL BRICKS - GREENDALE ROAD (50yr life)	D	8,676,250	0.0935	\$64,898	\$64,898	\$64,898	\$64,898	\$64,898	\$324,492
TOTAL CONTRIBUTIONS				\$461,983	\$237,384	\$140,238	\$112,861	\$64,898	\$1,017,364

TABLE D: SCHEDULE OF WORKS 1993 - 2012 - WHOLE CAMDEN COUNCIL AREA (in \$1993)

ITEM	DISTRIBUTION %	CONTRIBUTOR	PHASE 1 1993-1996	PHASE 2 1997-2000	PHASE 3 2001-2004	PHASE 4 2005-2008	PHASE 5 2009-2012	TOTAL
MINOR MAINTENANCE	12.5	COUNCIL	\$174,202	\$173,893	\$122,522	\$137,404	\$44,499	\$652,520
		EXTRACTORS	\$74,506	\$74,374	\$52,403	\$58,768	\$19,032	\$279,082
HEAVY PATCHING	25.0	COUNCIL	\$348,403	\$347,786	\$245,044	\$274,808	\$88,999	\$1,305,040
		EXTRACTORS	\$149,012	\$148,747	\$104,805	\$117,535	\$38,065	\$558,164
MAJOR REPAIR	62.5	COUNCIL	\$871,008	\$869,464	\$612,611	\$687,021	\$222,496	\$3,262,599
		EXTRACTORS	\$372,529	\$371,869	\$262,013	\$293,838	\$95,161	\$1,395,410
TOTAL PER PHASE	100.0	COUNCIL	\$1,393,612	\$1,391,142	\$980,177	\$1,099,233	\$355,994	\$5,220,159
		EXTRACTORS	\$596,046	\$594,990	\$419,220	\$470,141	\$152,258	\$2,232,655
GRAND TOTAL PER PHASE			\$1,989,659	\$1,986,132	\$1,399,397	\$1,569,374	\$508,253	\$7,452,814

TABLE E: STATE & REGIONAL ROADS

ROAD	FROM	TO
ARGYLE STREET	CAMDEN VALLEY WAY	MURRAY STREET
BRINGELLY ROAD	NORTHERN ROAD	COWPASTURE ROAD
BROUGHTON STREET	MURRAY STREET	OLD HUME HIGHWAY
CAMDEN BYPASS	NARELLAN ROAD	OLD HUME HIGHWAY
CAMDEN VALLEY WAY	ARGYLE STREET	COWPASTURE ROAD (BOUNDARY)
CAWDOR ROAD	MURRAY STREET	COUNCIL BOUNDARY
COWPASTURE ROAD	CAMDEN VALLEY WAY	BRINGELLY ROAD
DRUITT LANE	OLD HUME HIGHWAY	COUNCIL BOUNDARY
MURRAY STREET	ARGYLE STREET	BROUGHTON STREET
NARELLAN ROAD	CAMDEN VALLEY WAY	COUNCIL BOUNDARY
NORTHERN ROAD	CAMDEN VALLEY WAY	BRINGELLY ROAD (BOUNDARY)
OLD HUME HIGHWAY	BROUGHTON STREET	CAMDEN BYPASS
OLD HUME HIGHWAY	CAMDEN BYPASS	COUNCIL BOUNDARY
RABY ROAD	CAMDEN VALLEY WAY	COUNCIL BOUNDARY

APPENDIX 3

BIBLIOGRAPHY

1. Longworth and McKenzie Pty Ltd, December 1981 "Elderslie Sand and Soil Deposits: Land Management Study, Vol VI - Summary Environmental Impact Statement".
2. Camden Council, "Council Meeting February 26, 1990 Minute 104/90"- Report on Roads Maintenance Levy - February 1990,.
3. Department of Planning, Sydney, April 1992 "Section 94 Contributions Plans Manual".
4. Land and Environment Court NSW No 10501 of 1987, 10502 of 1987, Coram: Stein J. of May, 1989. "Colin C Donges & Associates Pty Ltd v Baulkham Hills Council".
5. Land and Environment Court NSW No. 10544 of 1986, 10545 of 1986. Coram: Stein J of August 1987. "Capital Quarries Pty. Ltd. V. Gunning Council and Ors. and Yass Council and Ors".
6. Camden Council Government Gazette January 13, 1989 "Local Environmental Plan No. 46".
7. Camden Council Government Gazette February 21, 1992 "Local Environmental Plan No. 48".
8. Project Planning Associates Pty Ltd, July 1989 "Campbelltown, Camden, Wollondilly (Part) Regional Road Hierarchy Study".
9. Department of Environment and Planning "Sydney Regional Environmental Plan No. 9 (Extractive Industry) and Planning Report (1986)".
10. State Planning Authority of NSW 1973 "The New Cities of Campbelltown, Camden, Appin, Structure Plan".
11. National Association of State Road Authorities (N.A.A.S.R.A.) - 1987 Publication "A Guide to the Structural Design of Road Pavements".

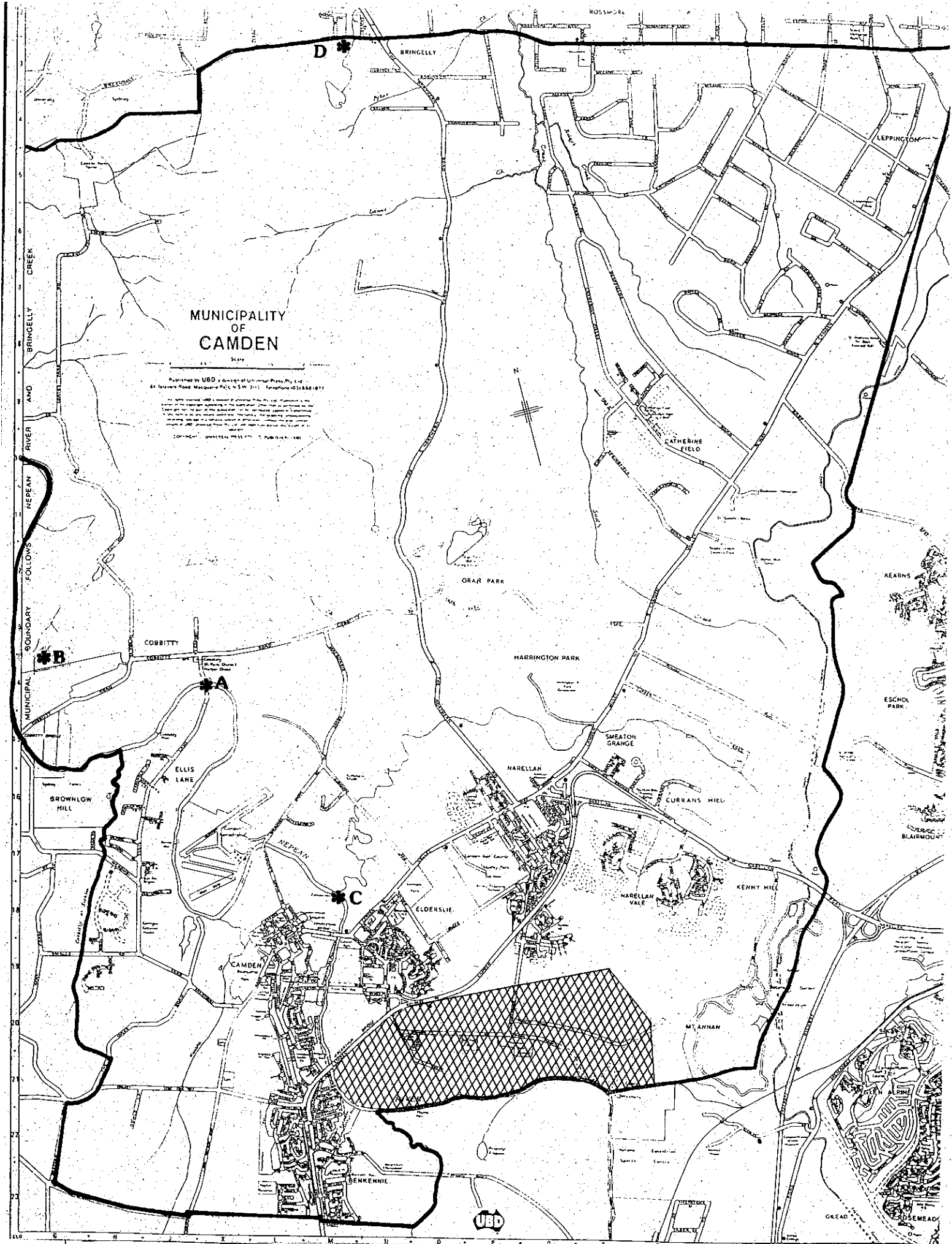

MAP A - AREAS TO WHICH THIS PLAN APPLIES



ELDERSLIE SAND AND SOIL DEPOSITS

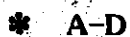

A-D OTHER EXTRACTION SITES WITH EXISTING DEVELOPMENT CONSENTS



COUNCIL BOUNDARY



MAP C: EXTRACT FROM REGIONAL ENVIRONMENTAL PLAN NO.9
(EXTRACTIVE INDUSTRY)

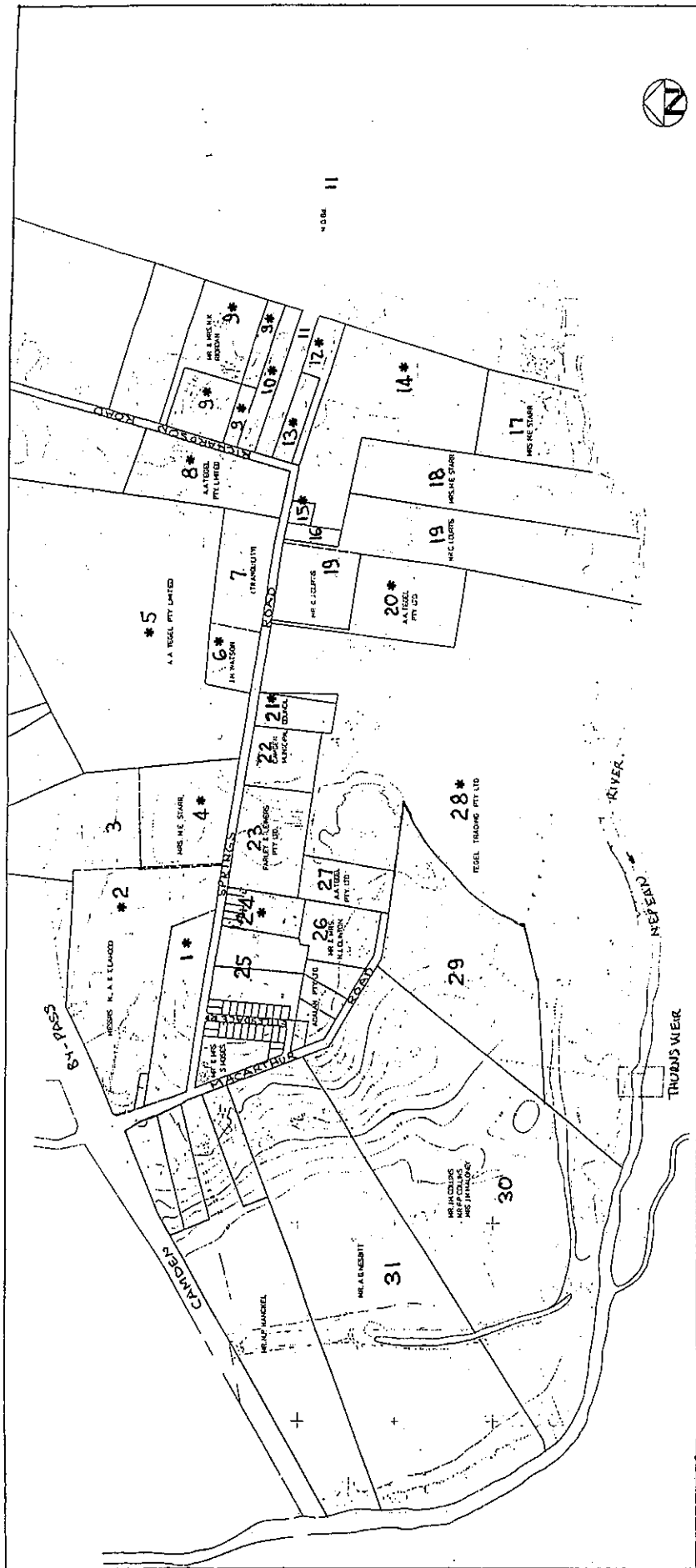

SITE	OWNER	SITE	OWNER
1	Mrs M.E. Starr - Hoxede P/L	17	Seovic Civil Engineering P/L
2	Mrs M.E. Starr - Hoxede P/L	18	H.A. & T. Lahood
3	Springs S/S - Camelot Resources	19	JM & WC Tripodi
4	Mrs M.E. Starr	20	Mrs M.E. Starr - Hoxede P/L
5	A.A. Tegel P/L (Inghams)	21	A.A. Tegel P/L (Inghams)
6	Camelot Resources (Springs-Garmark)	22	Camelot Resources (Springs-Garmark)
7	JM & WC Tripodi	23	Springvale Sands P/L - Menangle S/S
8	A.A. Tegel P/L (Inghams)	24	Springvale Sands P/L - Menangle S/S
9	NK & CF Riordan	25	Springvale Sands P/L - Menangle S/S
10	Riordan Family Trust	26	N.J. Clinton
11	Department of Housing	27	A.A. Tegel P/L (Inghams)
12	Clutha Services P/L	28	Indaal P/L - Cornish
13	Springvale Sands P/L - Menangle S/S	29	Springvale Sands P/L - Menangle S/S
14	Prospect County Council	30	M. Collins & Sons
15	Prospect County Council	31	M. Collins & Sons
16	Springs S/S - Camelot Resources		

OWNERS	SITES
1 Seovic Civil Engineering P/L	(1)
2 H.A. & T. Lahood	(2)
3 JM & WC Tripodi	(3,7)
4 Mrs M.E. Starr - Hoxede P/L	(4,17,18)
5 A.A. Tegel P/L (Inghams)	(5,8,20,27)
6 Camelot Resources (Springs-Garmark)	(6,16,19)
7 NK & CF Riordan	(9)
8 Riordan Family Trust	(10)
9 Department of Housing	(11)
10 Clutha Services P/L	(12)
11 Springvale Sands P/L - Menangle S/S	(13,23,25)
12 Prospect County Council	(14,15)
13 Camden Municipal Council	(21,22,24)
14 N.J. Clinton	(26)
15 Indaal P/L - Cornish	(28)
16 Tegel Trading P/L	(29)
17 M. Collins & Sons	(30,31)

EXTRACTION SITES SUBJECT TO A ROAD MAINTENANCE CONTRIBUTION

MAP D - ELDERSLIE SAND AND SOIL DEPOSITS : EXTRACTION SITES

MUNICIPALITY OF CAMDEN

Scale 0 5 10 Kilometres

Published by UBD a division of Universal Press Pty Ltd
84 Telavara Road, Macquarie Park, N.S.W. 2113 Telephone (02) 9688 1877

All rights reserved. UBD is a division of Universal Press Pty Ltd. Reproduction in the
entire or in part of this publication for any purpose other than as permitted by the
Copyright Act, the part of the publication for the reproduction, copying or in any form or by any means, electronic, mechanical, photocopying, recording, or otherwise, without the prior written
consent of UBD Universal Press Pty Ltd is prohibited. Copyright © 1990

COPYRIGHT - UNIVERSAL PRESS PTY LTD - PUBLISHED 1990

MAP E: STATE AND REGIONAL ROADS

TABLE A 1 : CONTRIBUTION RATE (1993) WITHIN ELDERSLIE SAND & SOIL DEPOSITS (UNAPPROVED)

(DERIVED FROM COUNCILS REPORT ON ROAD MAINTENANCE LEVY)

TEST AREA	TOTAL TONNAGE	RATE PER TONNE	TOTAL CONTRIBUTION
RICHARDSON ROAD	6,804,400	\$0.3947	\$2,606,757
SPRINGS ROAD & MACARTHUR ROAD	27,204,400	\$0.0533	\$1,448,995
TOTAL	33,808,800	\$0.4480	\$4,056,751

TABLE A 2 : CONTRIBUTION RATE (1993) : OUTSIDE ELDERSLIE SAND & SOIL DEPOSITS : (APPROVED)

(DERIVED FROM ?????????????????????)

TEST AREA	TOTAL TONNAGE	RATE PER TONNE	TOTAL CONTRIBUTION
		\$0.3753	
TOTAL		\$0.3753	

TABLE B 1 : APPORTIONMENT OF CONTRIBUTION : WITHIN ELDERSLIE SAND & SOIL DEPOSITS (UNAPPROVED)

(DERIVED FROM COUNCILS REPORT ON ROAD MAINTENANCE LEVY)

TEST AREA	RATE PER TONNE	EXTRACTION TONNAGE	EXTRACTION CONTRIBUTION	PROPORTION	OTHER (COUNCIL)
RICHARDSON ROAD	\$0.3947	2,712,700	\$1,070,703	26%	
SPRINGS ROAD & MACARTHUR ROAD	\$0.0533	2,712,700	\$144,587	4%	
TOTAL	\$0.4480	5,425,400	\$1,215,290	30%	

TABLE B 2 : APPORTIONMENT OF CONTRIBUTION : OUTSIDE ELDERSLIE SAND & SOIL DEPOSITS (APPROVED)

(DERIVED FROM ?????????????????????)

TEST AREA	RATE PER TONNE	EXTRACTION TONNAGE	EXTRACTION CONTRIBUTION	PROPORTION	OTHER (COUNCIL)
TOTAL					

TABLE C 1 : ANTICIPATED CONTRIBUTIONS 1993 - 2012 : WITHIN ELDERSLIE SAND & SOIL DEPOSITS (UNAPPROVED)

SOURCE	SITE NOS.	TOTAL TONNAGE	CONTRIBUTION RATE	APPORTIONMENT	PHASE
EXTRACTION SITES (OWNERS)					
SEOVIC CIVIL ENGINEERING P/L	1				
H. A. & T. LAHOOD	2				
J. M. & W. C. TRIPODI	3, 7				
M. E. STARR, HOXEDE P/L	4, 17, 18				
A. A. TEGAL P/L (INGHAMS)	5, 8, 20, 27				
CAMELOT RESOURCES (SPRINGS - GARMARK)	6, 18, 19				
N. K. & C. F. RIORDAN	9				
RIORDAN FAMILY TRUST	10				
DEPARTMENT OF HOUSING	11				
CLUTHA SERVICES P/L	12				
SPRINGVALE SANDS P/L, MENANGLE SAND & SOIL	13, 23, 25				
PROSPECT COUNTY COUNCIL	14, 15				
CAMDEN COUNCIL	21, 22, 24				
N. J. CLINTON	26				
INDAAL P/L, CORNISH	28				
TEGAL TRADING P/L	29				
M. COLLINS & SONS	30, 31				
SUB TOTAL			\$0.4480	30 %	
OTHER (COUNCIL)					
SUB TOTAL			\$0.4480	70 %	
TOTAL			\$0.4480	100 %	

TABLE C 2 : ANTICIPATED CONTRIBUTIONS 1993 - 2012 : OUTSIDE ELDERSLIE SAND & SOIL DEPOSIT

SOURCE	SITE NOS.	TOTAL TONNAGE	CONTRIBUTION RATE	APPORTIONMENT	PHASE
EXTRACTION SITES (OWNERS)					
NEPEAN DREDGING P/L					
COLLINS & SONS, KENMERE					
T. J. & R. F. FORDHAM					
BORAL BRICKS					
SUB TOTAL			\$0.3753	30 %	
OTHER (COUNCIL)					
SUB TOTAL				70 %	
TOTAL				100 %	

TABLE D : SCHEDULE OF WORKS 1993 - 2012 : WITHIN & OUTSIDE ELDERSLIE SAND & SOIL DEPOSIT

ITEM	APPORTIONMENT	CONTRIBUTOR	PHASE 1 1993 - 1996	PHASE 2 1997 - 2000	PHASE 3 2001 -
MINOR MAINTENANCE	12.5 %	EXTRACTION SITES			
		COUNCIL			
HEAVY PATCHING	25.0 %	EXTRACTION SITES			
		COUNCIL			
MAJOR REPAIR	62.5 %	EXTRACTION SITES			
		COUNCIL			
SUB TOTAL	100 %	EXTRACTION SITES			
		COUNCIL			
TOTAL	100 %				

TABLE C-1 ANTICIPATED CONTRIBUTIONS 1993 TO 2012 - ELDERSLIE SAND & SOIL DEPOSITS (in \$1993)
(CURRENTLY IDENTIFIED SITES WITH NO VALID DEVELOPMENT CONSENT AS AT 1/7/93)

LOCATION	SITE NO.	EXTRACTION TONNAGE	RATE \$/TONNE	PHASING IS FROM JULY TO JUNE					TOTAL
				PHASE 1 1993-1996	PHASE 2 1997-2000	PHASE 3 2001-2004	PHASE 4 2005-2008	PHASE 5 2009-2012	
AA TEGEL SPRINGS RD (LOT1DP228039)	20	160,000	0.4480	\$23,893	\$47,786				\$71,679
CAMDEN COUNCIL NIGHT SOIL DEPOT	21	30,000	0.4480					\$13,440	\$13,440
H A & T LAHOOD	2	520,600	0.4480	\$23,154	\$116,616	\$87,462			\$233,232
MENANGLE(SPRINGVALE)S&S & CLUTHA	12,13	180,000	0.4480	\$26,880	\$53,760				\$80,640
MRS M E STARR(HOXEDE)	4	650,000	0.4480		\$58,240	\$116,480	\$116,480		\$291,200
CAMDEN COUNCIL ONEIL HOUSES	24	75,000	0.4480			\$16,800	\$16,800		\$33,600
RICHARDSON ROAD RESERVE		40,000	0.4480					\$17,920	\$17,920
N K & C F RIORDAN	9,10	302,100	0.4480	\$54,136	\$81,204				\$135,340
SPRINGS ROAD RESERVE		455,000	0.4480			\$58,240	\$116,480	\$29,120	\$203,840
AA TEGEL CNR RICHARDSON ROAD	8	300,000	0.4480				\$107,520	\$26,880	\$134,400
TOTAL CONTRIBUTIONS				\$134,063	\$357,606	\$278,982	\$357,280	\$87,360	\$1,215,291

TABLE C-2: ANTICIPATED CONTRIBUTIONS 1993 TO 2012 (in \$1993)

(CURRENTLY IDENTIFIED SITES WITH CURRENT DEVELOPMENT CONSENTS AS AT 1/7/93)

(CURRENTLY IDENTIFIED SITES WITH CURRENT DEVELOPMENT CONSENTS AS AT 1/7/93)										PHASING IS FROM JULY TO JUNE				
LOCATION	SITE NO	EXTRACTION TONNAGE	RATE \$/TONNE	PHASE 1 1993 - 1996	PHASE 2 1997 - 2000	PHASE 3 2001 - 2004	PHASE 4 2005 - 2008	PHASE 5 2009 - 2012	TOTAL					
ELDERSLIE SAND & SOIL DEPOSITS														
AA TEGELWATSON BATTERS	5,6	15,000	0.4480	\$6,720					\$6,720					
PROSPECT COUNTY COUNCIL	14,15	550,000	0.4480	\$109,511	\$109,511	\$27,378			\$246,400					
SEOVIC CIVIL ENGINEERING	1	200,000	0.4480	\$89,600					\$89,600					
WOODGRAND (INDAAL)- THURNS WEIR	28	190,000	0.4480	\$85,120					\$85,120					
OUTSIDE ELDERSLIE														
NEPEAN DREDGING - ELLIS LANE	A	120,000	0.3753	\$30,024	\$15,012				\$45,036					
COLLINS -KENMERE- COBBITTY RD	B	511,189	0.3753	\$47,962	\$47,962	\$47,962	\$47,962		\$191,849					
FORDHAMS -ARGYLE ST(CAMDEN WEIR)	C	75,000	0.3753	\$28,148					\$28,148					
BORAL BRICKS - GREENDALE ROAD (50yr life)	D	8,676,258	0.0935	\$64,898	\$64,898	\$64,898	\$64,898	\$64,898	\$324,492					
TOTAL CONTRIBUTIONS				\$461,983	\$237,384	\$140,238	\$112,861	\$64,898	\$1,017,364					

TABLE C-1 ANTICIPATED CONTRIBUTIONS 1993 TO 2012 - ELDERSLIE SAND & SOIL DEPOSITS (in \$1993)
(CURRENTLY IDENTIFIED SITES WITH NO VALID DEVELOPMENT CONSENT AS AT 1/7/93)

LOCATION	SITE NO.	EXTRACTION TONNAGE	RATE \$/TONNE	PHASE 1 1993-1996	PHASE 2 1997-2000	PHASE 3 2001-2004	PHASE 4 2005-2008	PHASE 5 2009-2012	TOTAL
AA TEGEL SPRINGS RD (LOT1DP228039)	20	160,000	0.4480	\$23,893	\$47,786				\$71,679
CAMDEN COUNCIL NIGHT SOIL DEPOT	21	30,000	0.4480					\$13,440	\$13,440
H A & T LAHOOD	2	520,600	0.4480	\$29,154	\$116,616	\$87,462			\$233,232
MENANGLE(SPRINGVALE)S&S & CLUTHA	12,13	180,000	0.4480	\$26,880	\$53,760				\$80,640
MRS M E STARR(HOXEDE)	4	650,000	0.4480		\$58,240	\$116,480	\$16,800		\$291,200
CAMDEN COUNCIL ONEIL HOUSES	24	75,000	0.4480						\$33,600
RICHARDSON ROAD RESERVE		40,000	0.4480					\$17,920	\$17,920
N K & C F RIORDAN	9,10	302,100	0.4480	\$54,136	\$81,204				\$135,340
SPRINGS ROAD RESERVE		455,000	0.4480			\$58,240	\$116,480	\$29,120	\$203,840
AA TEGEL CNR RICHARDSON ROAD	8	300,000	0.4480				\$107,520	\$26,880	\$134,400
TOTAL CONTRIBUTIONS				\$134,063	\$357,606	\$278,982	\$357,280	\$87,360	\$1,215,291

TABLE C-2: ANTICIPATED CONTRIBUTIONS 1993 TO 2012 (in \$1993)
(CURRENTLY IDENTIFIED SITES WITH CURRENT DEVELOPMENT CONSENTS AS AT 1/7/93)

LOCATION	SITE NO.	EXTRACTION TONNAGE	RATE \$/TONNE	PHASE 1 1993-1996	PHASE 2 1997-2000	PHASE 3 2001-2004	PHASE 4 2005-2008	PHASE 5 2009-2012	TOTAL
ELDERSLIE SAND & SOIL DEPOSITS									
AA TEGEL/WATSON BATTERS	5,6	15,000	0.4480	\$6,720					\$6,720
PROSPECT COUNTY COUNCIL	14,15	550,000	0.4480	\$109,511	\$109,511	\$27,378			\$246,400
SEOVIC CIVIL ENGINEERING	1	200,000	0.4480	\$89,600					\$89,600
WOODGRAND (INDAAL) - THURNS WEIR	28	190,000	0.4480	\$85,120					\$85,120
OUTSIDE ELDERSLIE									
NEPEAN DREDGING - ELLIS LANE	A	120,000	0.3753	\$30,024	\$15,012				\$45,036
COLLINS - KENMERE- COBBITTY RD	B	511,189	0.3753	\$47,962	\$47,962	\$47,962	\$47,962		\$191,849
FORDHAMS - ARGYLE ST(CAMDEN WEIR)	C	75,000	0.3753	\$28,148					\$28,148
BORAL BRICKS - GREENDALE ROAD (50yr life)	D	8,676,250	0.0935	\$64,898	\$64,898	\$64,898	\$64,898	\$64,898	\$324,492
TOTAL CONTRIBUTIONS				\$461,983	\$237,384	\$140,238	\$112,861	\$64,898	\$1,017,364

-TABLE D: SCHEDULE OF WORKS 1993 - 2012 - WHOLE CAMDEN COUNCIL AREA (in \$1993)

ITEM	DISTRIBUTION %	CONTRIBUTOR	PHASE 1 1993-1996	PHASE 2 1997-2000	PHASE 3 2001-2004	PHASE 4 2005-2008	PHASE 5 2009-2012	TOTAL
MINOR MAINTENANCE	12.5	COUNCIL	\$174,202	\$173,893	\$122,522	\$137,404	\$44,499	\$652,520
		EXTRACTORS	\$74,506	\$74,374	\$52,403	\$58,768	\$19,032	\$279,082
HEAVY PATCHING	25.0	COUNCIL	\$348,403	\$347,786	\$245,044	\$274,808	\$88,999	\$1,305,040
		EXTRACTORS	\$149,012	\$148,747	\$104,805	\$117,535	\$38,065	\$558,164
MAJOR REPAIR	62.5	COUNCIL	\$871,008	\$869,464	\$612,611	\$687,021	\$222,496	\$3,262,599
		EXTRACTORS	\$372,529	\$371,869	\$262,013	\$293,838	\$95,161	\$1,395,410
TOTAL PER PHASE	100.0	COUNCIL	\$1,393,612	\$1,391,142	\$980,177	\$1,099,233	\$355,994	\$5,220,159
		EXTRACTORS	\$596,046	\$594,990	\$419,220	\$470,141	\$152,258	\$2,232,655
GRAND TOTAL PER PHASE			\$1,989,659	\$1,986,132	\$1,399,397	\$1,569,374	\$508,253	\$7,452,814